



SC-200

SWING TYPE CHECK VALVE**GENERAL FEATURES**

Check valves has several advantages such as improving safety, easy installing.

Check valves provide the flows just one way. When liquid flows through to flowing direction, check valves open and let it pass. But liquid tries to flow opposite direction of flowing, check valves close and prevent passing.

Connection:

Threaded

Nominal Diameter:

DN15 (1/2") - DN50 (2")

Pressure Range:

PN16

Working Temperature:

-10°C to 180°C

Typical Applications:

- Water and condensate lines
- Heating air-conditioning systems
- Waterworks
- Air pipelines
- Paper mills
- Plant processes
- Shipbuilding
- Vessel pipelines
- Mineral, oil industry
- Textile industry



SC-200 SWING TYPE CHECK VALVE

DIMENSIONS								
Size (mm)	1/2"	3/4"	1"	1 - 1/4"	1 - 1/2"	2"	2 - 1/2"	3"
A	15	20	25	32	40	50	65	80
(H)	42	51	60	67	75	81	93	104
L	65	80	90	105	120	140	180	200
T	1/2 NPT or PF	3/4 NPT or PF	1 NPT or PF	1 - 1/4 NPT or PF	1 - 1/2 NPT or PF	2 NPT or PF	2 - 1/2 NPT or PF	3 NPT or PF

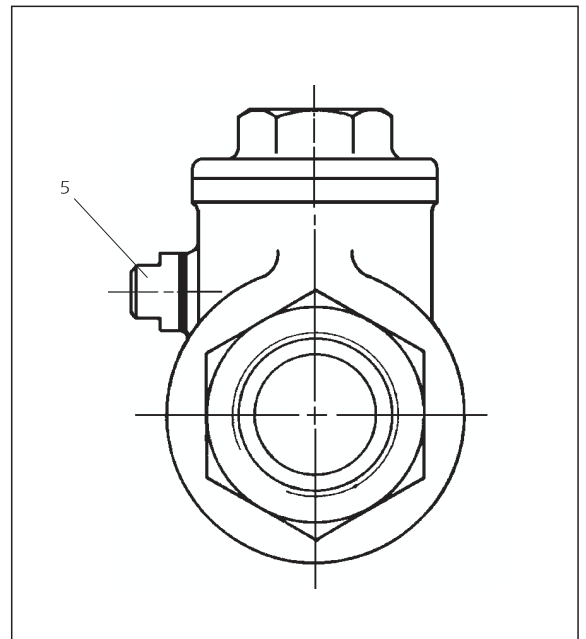
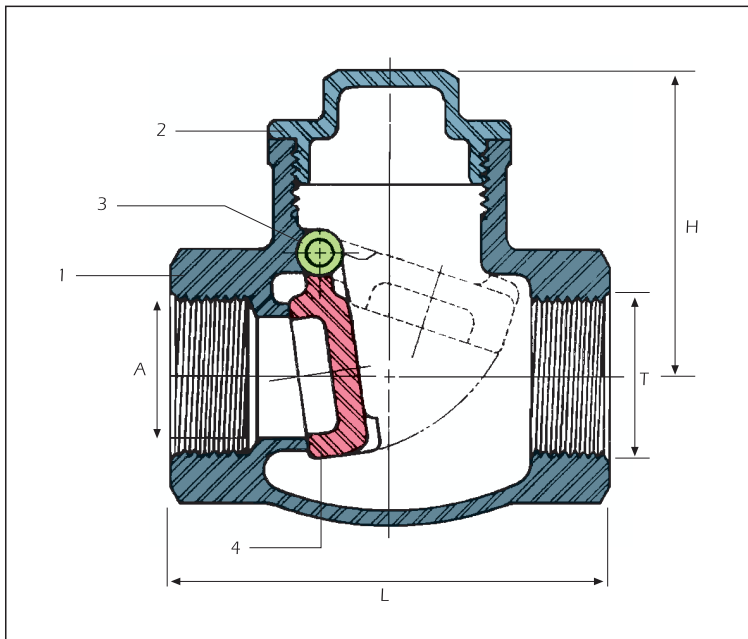

SPARE PARTS		
NO	PART NAME	MATERIAL
1	Body	Stainless Steel AISI 304
2	Cover	Stainless Steel AISI 304
3	Hinge Pin	Stainless Steel AISI 304
4	Hinge	Stainless Steel AISI 304
5	Hinge Stem	Stainless Steel AISI 304

Optional AISI 316